

STATISTICS

ACRES: 1.8
 PARKING SPACES: 88' x 51' - ASPHALT
 FACILITIES:
 * SWINGS (4 REGULAR, 3 TOT)

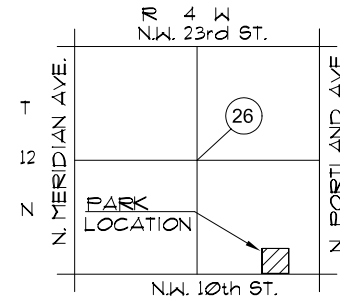

NOTES:

1. PARK BOUNDARY IS APPROXIMATE LOCATION ONLY.
2. LOCATION OF IMPROVEMENTS IS CONCEPTUAL. VERIFY LOCATION IN FIELD.