

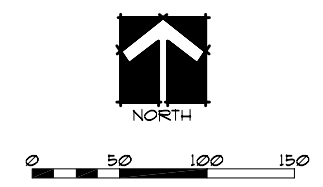

STATISTICS

- ACRES: 1.3
- PARKING SPACES: 88' x 51' - ASPHALT
- FACILITIES:
 - * PLAYGROUND EQUIPMENT - 1999
 - * (3) ADULT BASEBALL FIELD - NO LIGHTS

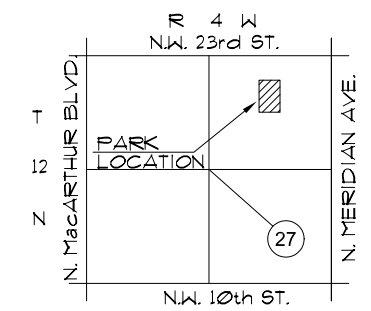

- NOTES:
1. PARK BOUNDARY IS APPROXIMATE LOCATION ONLY.
 2. LOCATION OF IMPROVEMENTS IS CONCEPTUAL. VERIFY LOCATION IN FIELD.

HARLOW PARK

NW 19th & HARLOW - WARD 3

City of Oklahoma City
Parks and Recreation Department
JUNE 1998 / OCT 2000