

STATISTICS

- ACRES: 20
- PARKING SPACES: ON STREET
- FACILITIES:
 - * METAL PLAYGROUND EQUIPMENT
 - * (1) BACKSTOP
 - * LANDSCAPE PLANTING BED
 - * PARK BENCHES

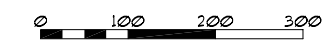
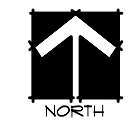
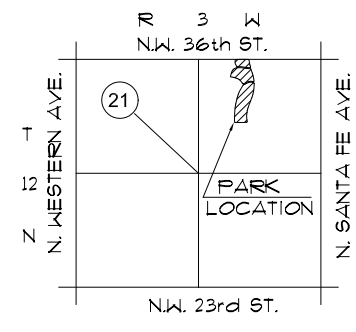

NOTES:

1. PARK BOUNDARY IS APPROXIMATE LOCATION ONLY.
2. LOCATION OF IMPROVEMENTS IS CONCEPTUAL. VERIFY LOCATION IN FIELD.

EDGEMERE PARK

NW 33rd & HARVEY - WARD 2 - DEED RESTRICTION

City of Oklahoma City
Parks and Recreation Department
APRIL 1998 / JAN 2000