

STATISTICS

ACRES: 2.4
 PARKING SPACES: N/A
 FACILITIES:
 * METAL PLAYGROUND EQUIPMENT

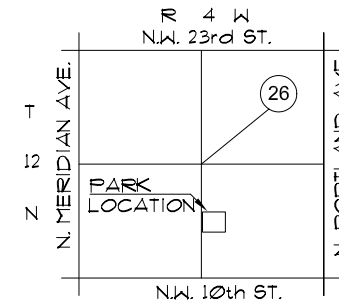

NOTES:

1. PARK BOUNDARY IS APPROXIMATE LOCATION ONLY.
2. LOCATION OF IMPROVEMENTS IS CONCEPTUAL. VERIFY LOCATION IN FIELD.

GRANT CORBIN PARK

NW 12th & TULSA - WARD 3 - DEED RESTRICTION

City of Oklahoma City
 Parks and Recreation Department
 JUNE 1998 / MAY 2002