

**STATISTICS**

- ACRES: 5 ACRES (330' X 660')
- PARKING: 102' X 23' OF PARKING AREA  
DIRT SURFACE W/ POST & CABLE
- FACILITIES:
- METAL PLAYGROUND EQUIPMENT
  - 1 YOUTH SOFTBALL FIELD (211FT.)
  - BASKETBALL COURT - 1 GOAL
  - PICNIC SHELTER

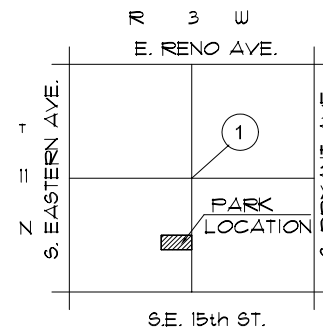

**NOTES:**

1. PARK BOUNDARY IS APPROXIMATE LOCATION ONLY.
2. LOCATION OF IMPROVEMENTS IS CONCEPTUAL. VERIFY LOCATION IN FIELD.

**BOB AKERS PARK**

SE 11th & FAIRMONT - WARD 7

City of Oklahoma City  
Parks and Recreation Department  
APRIL 1998 / OCT 1999